

 **Nu-Calgon**  
INJECTION VALVE

**4300-89**  
**(43000)**

# INJECTION VALVE

*for Rx11-flush<sup>®</sup> and  
Rx-Acid Scavenger<sup>®</sup>*



 **Nu-Calgon**

2611 Schuetz Rd.  
St. Louis, MO 63043  
[www.nucalgon.com](http://www.nucalgon.com)

**4300-89**  
**(43000)**

## INJECTION VALVE

for Rx11-flush® and Rx-Acid Scavenger®

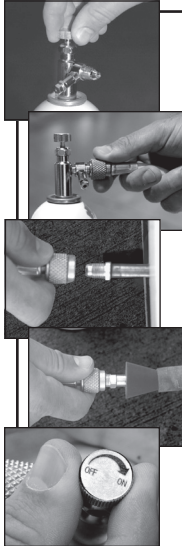

### INSTRUCTIONS FOR USE:

- 1** Assure knob on Injection Valve is turned all the way counter clockwise and thread onto top of canister. Attach snugly but do not over tighten.
- 2** Attach charging hose to Injection Valve.
- 3** Attach other end of charging hose to schrader valve at point of injection.
- 4** If flushing line sets with Rx11-flush, attach Flushing Tool (4300-50) or Rx11-flush Gun (4300-51) to charging hose and place in line set at injection point.
- 5** Twist the knob on Injection Valve clockwise to inject Rx11-flush, A/C Re-New, or Rx-Acid Scavenger. Twist counter clockwise to stop releasing the product.

The Injection Valve (4300-89) is equipped with an audible pressure relief alarm that will sound if canister is inadvertently connected to a source of high pressure. If alarm sounds, immediately disconnect hose from source of high pressure. The valve is set to factory specs and should not be adjusted.

**WARNING:** This dispensing valve is tested and approved for use only with Nu-Calgon products. Use with anything other than Nu-Calgon products may compromise designed safety features resulting in serious injury.



00681001430005

Qty 1

**B13-402**

4300-89 VALVE INJECTION ASB

TOL03481

VALVE INJECTION ASSEMBLY

4300-89



1 EA CS

1 2T749



4300-89

(316)

Visit [www.nucalgon.com](http://www.nucalgon.com) for more product information.